



ReadykeyPRO System Overview

- ▶ Enhanced Imaging
- ▶ Image export
- ▶ Support for 64-bit credential (card, token, or adhesive tag) numbers
- ▶ iCLASS integration with Smart Card encoding capabilities
- ▶ Enhanced options for alarm monitor zones and credential time periods
- ▶ Global input and output (I/O)
- ▶ Global anti-passback
- ▶ Windows® XP operating system compatibility
- ▶ Support for:

ReadykeyPRO is a Microsoft® Windows® 2000 certified product designed and written by a Microsoft Certified Gold Partner. It supports industry standard databases, networks, and identification card printers.

ReadykeyPRO is an application compliant with open database connectivity (ODBC). ReadykeyPRO comes standard with an MSDE 2000 database and supports Microsoft® SQL Server 2000.

ReadykeyPRO offers streamlined database administration, advanced alarm monitoring, and flexible hardware topology. The system includes online help screens, system configuration setup wizards, and copy templates.

System Overview

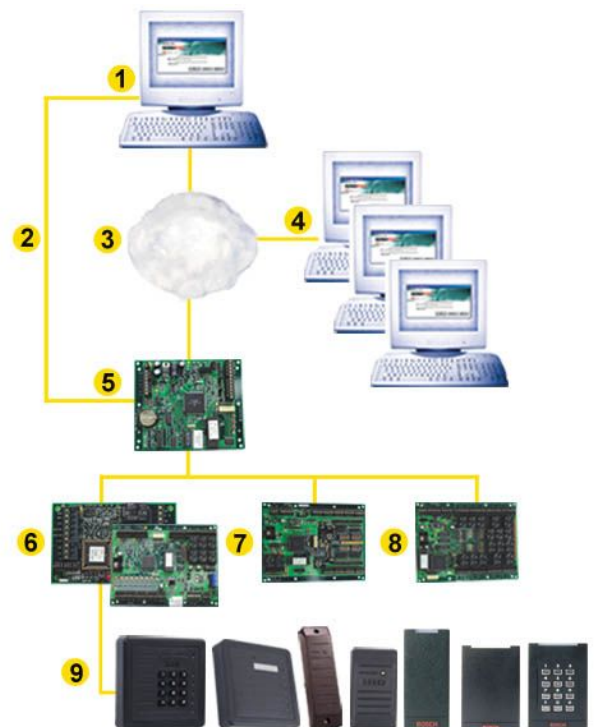

- 1 Server
- 2 RS-232 connection from the server to the ISC

- 3 Ethernet TCP/IP LAN/WAN
- 4 Workstations
- 5 ISC
- 6 Reader Interfaces
- 7 Input Module
- 8 Output Module
- 9 Readers

The hardware communicates over local-area or wide-area networks (LAN or WAN), TCP/IP, RS-232, RS-485 per port, and dial-up communications. The system works with existing facility communication topology to reduce installation costs.

Each intelligent system controller (ISC) can connect to a combination of up to 16 devices. Connect single and dual reader interfaces, input control modules, and output control modules to the ISC over a 4000 ft (1219 m) per port RS-485 wire bus. The ISC uses a 32-bit processor to command all downstream modules using a 38.4 kbps communication.

Functions

Enhanced Imaging

Includes a Chromakey feature that removes a solid background from a captured image. Includes an adjustable ghosting feature that makes a photo look semi-transparent.

Image Export

Allows users to export images to a .jpg file format

Support for 64-bit Credential Numbers

Allows system administrators to specify credential identification numbers up to 18 digits. Ideal for smart cards and advanced applications.

Assign Alarm Monitoring Zones to Workstations

Assign ReadykeyPRO monitor zones to ReadykeyPRO users as well as to client workstations. Supervisors and other can log into any alarm monitoring workstation to monitor areas of responsibility.

Enhanced Credential Options

Set time periods for specific groups of users. Restrict some users to access only during regular business hours, extend access to include additional hours, or set different time periods. Set the specific time and date to deactivate a credential (card, token, or adhesive tag).

Global Anti-passback

Increases the area over which users can apply anti-passback. Configure areas that span across each ISC.

Global Input/Output Cross Controller

Configure input and output (I/O) linkages that span across each ISC. Use input actions made under one ISC to activate outputs under another ISC. Extend I/O functions across large geographic distances.

Time Zones

Create and store 255 time zones with a maximum of six intervals. Assign an interval to any day of the week. Users can also restrict an interval to a holiday.

Access Levels

Define 255 levels and assign 32 levels to each person or group.

Holidays

Assign 255 holiday dates and eight different holiday categories. Assign holidays to individual time zones.

Anti-passback

This function works when a user attempts to exit one area and enter another area. Before the user can use another entry reader to access another area, the user must provide the exit reader with a valid credential.

Two Card Control

The reader must accept the credentials of two authorized users in order to grant access.

Occupancy Limit

Places a limit on the number of authorized card holders that can simultaneously occupy an area.

Database Segmentation

Available for Expansion and PRO level systems. Requires Microsoft® SQL Server 2000. Divide each database object (access levels, alarm inputs, areas, card readers, and users) into a segment with unique parameters. For example, each segment could have 255 access levels, 255 time zones, and 255 holidays.

Note Database segmentation is only available with Expansion or PRO level systems. Contact application support for details.

System Administration and Identification Management

Administer system-wide security and manage database inquiries. Configure client access to screens and monitoring functions. Use the log and report capabilities to retrieve operator activity, system events and database information.

Multiple Drop ISC Support

Supports a multiple-drop ISC architecture. Connect up to eight ISC units to one RS-485 communications line. All eight ISC units will communicate back to one serial communications port.

Alarm Monitoring

The monitoring screen depicts the location, time, and priority of an alarm. Locate alarms with a map, a system status tree, or an alarm menu. Sort or insert alarms based on priority, date/time, alarm description, controller, card-reader, or user.

Elevator Control

Control a user's access to specific floors. The number of floors that the administrator can control varies according to the system hardware.

Extended Read Time Control

- **Extended Strike Time**
Selectable by person. Program an amount of time from 0 to 255 seconds. Program a unique amount of time for each reader.
- **Extended Door-held-open Time**
Selectable by person. Program an amount of time from 0 to 255 seconds. Program a unique amount of time for each reader.

Alarm Masking Control

Mask (disarm) or unmask (arm) an individual input or a group of inputs. This process creates an environment that is similar to an intrusion system. The system supports 64 alarm masking groups per ISC.

Map Designer

Import image files and attach custom icons to create interactive maps of an entire facility or of a specific building/floor.

Optional Functions

CCTV Interface

Send ASCII control commands to closed circuit television (CCTV) cameras or monitors.

Badge Designer

Create custom badge designs. Badge Designer supports credit card, government, and custom identification card sizes. Badge Designer supports landscape or portrait format as well as double-sided and edge-to-edge printing.

Technical Specifications

System PC Requirements

Communication Requirements

CD-ROM:	20/48X
Floppy Disk Drive:	3.5 in., 1.44 MB
Hard Disk Drive:	10 GB, 7200 RPM, IDE
Internet Browser:	Internet Explorer 5.5 or higher
Modems:	56KBps (if dial communications are required)
Ports:	1 serial 1 USB (required for dongle or security key) <i>Add port types based on system configuration requirements as necessary</i>
TCP/IP:	10/100 Ethernet NIC

Multimedia Components

Audio with Speakers:	Windows® compatible
Keyboard:	Windows® compatible
Monitor:	1024 x 768 screen area
Mouse:	Windows® compatible
Printers:	Windows® compatible
Video Card:	16 MB

Operating System

Windows® 2000 SP4
Windows® XP SP1a only

Processor

Pentium IV® 1.5 GHz
Intel Celeron® processors are not supported

RAM/Memory

256MB

ReadykeyPRO System Specifications

Number of . . .

Access Levels:	255 standard 32,000 maximum with third party database applications
Card Holders:	5,000 standard 13,000 or more with SQL Server 2000 software
Card Readers:	64
Database Divisions (Segments):	65,000 with SQL Server 2000 Available only for Expansion and PRO level systems. Contact application support for details.
Events:	Limited according to the amount of available server database disk space

Product Overview for ReadykeyPRO

Here is a list of ReadykeyPRO products offered by Bosch Security Systems.

Hardware Options

Controller and Module Hardware

LNL-500	ISC with 512KB memory
LNL-1000	ISC with 1MB memory
LNL-1100	16 Input monitor module
LNL-1200	16 Output control module
LNL-1300	Single reader interface module

Controller and Module Hardware

LNL-1320	Dual reader interface module
LNL-8000	Star multiplexer
LNL-CONV-1	Adapter plate for single LNL-1300
LNL-CONV-4	Adapter plate for up to four double LNL-1300

Communications Hardware

HOC-56KEXT	Communications cable for 56K modem
HOC-BC00301	PC to modem cable
HOC-ETHLAN	Communications cable
LNL-837A	High speed line driver
LNL-838A	High speed line driver with optical isolation
LNL-108A	RS-232 to RS-485 converter
LNL-109A	RS-232 to RS-485 converter with optical isolation
LNL-56KEXT	56K External modem
LNL-DC336K	33.6K External modem
LNL-ETHLAN	Network module for LNL-1000
LNL-ETHLAN-MICR	Network module for LNL-500

Door Controller Kits

LNL-2DRKIT	ReadykeyPRO two-door controller kit
RKP-DEMO	Hardware demo kit
RKP-DEMOCASE	Padded shipping case for demo kit

Optional Accessories

RKP-CHROMKEY	Green-blue backdrop
--------------	---------------------

Power Supply and Enclosure Hardware

ABT-12	Battery kit
LNL-CAM 1	Lock assembly and keys
RK-AL400ULX	Enclosure with power supply (4 A)
RK-AL600ULX4CB6	Large enclosure with power supply (6 A)
RK-CTX	Enclosure without a power supply
RK-CTX-6	Large enclosure without a power supply

Printers and Accessories

MC-CLEANINGKIT	Printer cleaning kit
MC-CUSTOMKEY	Holokote custom logo setup and secure key
MC-PVCBLNK-1000	Blank PVC cards (package of 1,000)
MC-PVCSTICKY	Adhesive-backed PVC cards (package of 1,000)
MC-RIO2-MAG*	Rio Single Sided Card Printer with Mag Encoder
MC-RIO2	Rio Single Sided Card Printer
MC-RIO-YMCKO	Five-panel color dye film
MC-SECUREKEY	Holokote secure key
MC-TANGO2-MAG*	Tango Double Sided Card Printer with Mag Encoder
MC-TANGO2	Tango Double Sided Card Printer
MC-TANGO-YMCKOK	Six-panel color dye film

*ReadykeyPRO only

Proximity Readers and Credentials

D8222	Wiegand Key Insert Reader
D8223	Prox Pro reader
D8223-P*	Prox Pro PIN reader
D8224	Mullion reader

Controller and Module Hardware

D8224-SP	Switch plate reader
D8225	Mini-mullion reader
D8232-10	Wiegand Proximity Token, 26-bit (package of ten)
D8236-10	Wiegand Proximity Card, 26-bit (package of ten)
D8236KF-10	Wiegand Proximity Token, 26-bit (package of ten)
D8236TG-10	Wiegand Proximity Adhesive Tag, 26-bit (package of ten)
D8237-50*	Wiegand Photo Identification Card, 37-bit (package of 50)
D8237KF-10*	Wiegand Proximity Token, 37-bit (package of ten)
D8237TG-10*	Wiegand Proximity Adhesive Tag, 37-bit (package of ten)

* ReadykeyPRO only

iCLASS Contactless Smart Cards and Readers

ARD-RK10	iCLASS Mullion Reader
ARD-R40	iCLASS Switchplate Reader
ARD-RK40-09*	iCLASS PIN Reader
ARD-VSMART	iCLASS V-Smart Reader
ACD-IC2K26-50	iCLASS 2K Wiegand Card, 26-bit (package of 50)
ACD-IC2K37-50*	iCLASS 2K Wiegand Card, 37-bit (package of 50)
ACD-IC16K26-50	iCLASS 16K Wiegand Card, 26-bit (package of 50)
ACD-IC16K37-50*	iCLASS 16K Wiegand Card, 37-bit (package of 50)
ACD-IC16KP26-50	iCLASS 16K Dual Wiegand Card, 26-bit (package of 50)
ACD-IC16KP37-50*	iCLASS 16K Dual Wiegand Card, 37-bit (package of 50)
ACT-IC2K26-10	iCLASS 2K Wiegand Token, 26-bit (package of ten)
ACT-IC2K37-10*	iCLASS 2K Wiegand Token, 37-bit (package of ten)
ACT-IC16K26-10	iCLASS 16K Wiegand Token, 26-bit (package of ten)
ACT-IC16K37-10*	iCLASS 16K Wiegand Token, 37-bit (package of ten)
ACA-IC2K26-10	iCLASS 2K Wiegand Adhesive Tag, 26-bit (package of ten)
ACA-IC2K37-10*	iCLASS 2K Wiegand Adhesive Tag, 37-bit (package of ten)
ACA-IC16K26-10	iCLASS 16K Wiegand Adhesive Tag, 26-bit (package of ten)
ACA-IC16K37-10*	iCLASS 16K Wiegand Adhesive Tag, 37-bit (package of ten)

* ReadykeyPRO only

Software Options**Application Software**

RKP6200-S32 ReadykeyPRO Server License for 32 Readers

Software Option for Version 5.10 or Higher

RKP6210-INT Intrusion panel interface option

Software Options for version 5.9 or higher

RKP6210-DATAX Data exchange option

RKP6210-GT Guard tour option

RKP6210-M Real-time muster reporting option

Software Options

RKP6210-32 Upgrade from 32 to 64 reader option

RKP6210-CCTV CCTV serial output option

RKP6210-CL Additional client software license

RKP6210-CPID Photo identification software license

RKP6210-EMAIL Automatic e-mail interface option

RKP6210-FD Forms designer option

RKP6210-PG Automatic paging option

RKP6210-REC Receiver option

RKP6210-VV Video verification window upgrade

Software Option Accessories

RKP6220-EC Expanded cable

RKP6220-VB Video capture board

RKP-IMAGECAPKIT Complete video capture kit

This kit includes a PCI video capture card.

Europe, Middle East, Africa:
Bosch Security Systems B.V.
P.O. Box 80002
5600 JB Eindhoven, The Netherlands
Phone: +31 40 27 83955
Fax: +31 40 27 86668
emea.securitysystems@bosch.com
www.boschsecurity.com

Americas:
Bosch Security Systems
130 Perinton Parkway
Fairport, New York, 14450, USA
Phone: +1 800 289 0096
Fax: +1 585 223 9180
security.sales@us.bosch.com
www.boschsecurity.us

Asia-Pacific:
Bosch Security Systems Pte Ltd
38C Jalan Pemimpin
Singapore 577180
Phone: +65 6319 3450
Fax: +65 6319 3499
apr.securitysystems@bosch.com
www.boschsecurity.com

Represented by